

New Beginnings

Our house plans include much more than most.



A whole-way house.

Volume 2, Issue 3
April 2010

CocoaVin a Resounding Success!!

To say that CocoaVin was “An Indulgent Evening Benefiting the Summit House Triangle” would be a gross understatement!! And the families of Summit House are the beneficiaries of the incredibly generous sponsors, guests and donors who helped raise over \$30,000!

Over 200 guests came to mix & mingle, swirl & sample, and bid & buy at Artspace in downtown Raleigh on Saturday, April 24, 2010. The incredible generosity, artistry and culinary mastery of Kenton Jenkins and XU Catering set the tone for this indulgent affair. Lobster bisque, lobster stuffed wild mushrooms, beer

boiled prawns, succulent grilled beef fillet, roasted and grilled vegetables, and slow-roasted Coq au Vin were just a few of

the mouth-watering selections created for the lavish buffet.

The eight chocolatiers went all out to create magnificently special treats that wowed the taste buds, especially when paired with nine exquisite red wines, sparkling Nuvo and brut, and blueberry port. Paul Katsirubas of Wine & Things poured wine and was available for consultation and special-pricing wine orders. Chocolatiers Bonnie Lau of Miel Bon Bons, Teresa Wilkerson of WR Chocolatier, Reginald O. Savage of Azurelise Chocolate Truffles, and Hal Parson of Escazu Artisan Chocolates brought their exquisite creations personally and shared their treasures and stories with the guests.



John Moye, Pianist



Azurelise Chocolate Truffles paired with La Font du Vent Cote du Rhone Village Passion from France

CocoaVin continued page 2

The success of CocoaVin would not have been possible without the support of our sponsors:

Maitre D:



Chef-Patisserie:

Progress Energy Jones Day BB&T
Raleigh Foot & Ankle Center

Barista:

Rep. Jennifer Weiss
&
Mr. Bruce Hamilton

DocuSource of NC

pharmae
Kacvinsky llc

Board of Directors Corporate

Cathy Phillips, Chair
Rudolph Allen
Lovell Bryant
Karen Chapple
Jackie Nelson
Tracy Parr
Hon. Ripley Rand
Carroll Royster

Charlotte

Jeff Ziliani, Chair
Sonya Curry
Ginger Doherty
Margaret Harris
Renee Maillet
Erika Olson
Melissa Owen
Erin Steiner

Piedmont

Linda Higgins, Chair
Brian Cheek
Jody Eflord
Hon. Michelle Fletcher-Free
Dr. Shirley Morrison
Hon. Mary Rakestraw
Lisa Rozzelle
Bob Smithson
Hon. Kelly Thompson
Leslie Welch
Dr. Paula Weller
Linda Wilson

Triangle

Timothy Wilson, Chair
Sarah Atai
Dan Blue
Lauren Brennan
Emily Moseley
Jessica O'Mahony
Allison Taylor
Jennifer Wells
Christina Woelffer

Gratitude from a new Summit House Graduate

The two years I've spent at Summit House have been a learning experience for me. Prior to being a resident at Summit House, I was headed down the wrong path that almost led me to prison. Summit House has changed my life. I am truly grateful that there are programs such as this one that have given me a second chance and the opportunity to make a change, and make a difference in my life, as well as in my daughter's life.

"I will never forget where I came from, what I've been through and where I am going."

Everyday has not been a good day at Summit House, but through this process I have grown and learned that the consequences for my actions could have been worse. While living at Summit House, I have built a strong and loving relationship with my seven-year-old daughter. I have participated in weekly parenting classes and have been open-minded to suggestions that have been given to me from our on-site parenting specialist as well as case managers.

I've learned how to cook, clean and provide restaurant-style service in a commercial kitchen on a daily basis, with the training provided by our on-site kitchen manager. The staff at Summit House has helped and guided me in coping with stress, budgeting, expressing my feelings, making positive decisions, accepting the things I cannot change, having

healthy relationships with others, chemical dependency, life skills in general, and living life on life's terms. With the tools I have been given at Summit House, I know how to be a productive member of society.

It feels good to have gone through this experience clean from any mind-altering chemicals. I am especially proud to be the first African-American graduate of Summit House Piedmont since it has reopened, because most African-Americans don't get a second chance.

Like every resident, I've had my ups and downs while in the process of working this program. Everything happens for a reason and from that



Jackie Nelson, Corporate Board, Graduates K and daughter, Linda Higgins, Piedmont Chair and O'Shelia Williams, Piedmont Site Director

standpoint, I am a stronger person and stronger mother for my child.

I will never forget where I came from, what I've been through and where I am going. Thank you Summit House, for showing me a new way to live, believing in me and being very supportive to my daughter and me. You saw the best in me!



Win a Year of Free Tuition at Charlotte Academy of Music!

1 Year Tuition - 36 Private Lessons
(30 Minutes Plus Lab)
\$20 Per Ticket
Max. Odds of Winning 1:250
Drawing Date: August 21, 2010

All Proceeds Benefit Summit House

Three Ways to Purchase Raffle Tickets:

1. Inquire at the Front Desk
2. Call 704-545-7400
3. [Email](#) the Academy

Please make checks payable to Charlotte Academy of Music

CHARLOTTE ACADEMY
OF MUSIC



Buffet Selections by XU Catering

The silent auction was a flurry of activity as folks clamored to win treasures from over \$18,000 worth of donated items. Our local (and national) community donated items ranging from a cruise, spa treatments, and local restaurant certificates to fine jewelry, art and golf!

By far the true highlights of the evening were the incredible stories of success that Deborah and Tara shared with everyone. Both Summit House graduates are happily married, their children thriving under their mothers' love and commitment, and doing fabulously well at their jobs. We were honored that they were willing to openly share their journeys.

Because CocoaVin was such an extraordinarily successful evening that made one's senses dance, it is destined to become an annual event, where the blending of wine and chocolate benefit the families of Summit House for years to come.

Special thanks to everyone who made the evening a success...you are helping make second chances possible. Check out photos of the event taken by Sarah Wilson Fine Art Photography at www.summithouse.org.



Bonnie Lau and Miel Bon Bons' treats paired with Masi Campofiorin from Italy

The success of CocoaVin would not have been possible without the support of our sponsors:



Kilpatrick Stockton is proud to support the CocoaVin Wine and Chocolate Gala.

We applaud the **SUMMIT HOUSE** program and embrace its mission to break the multigenerational cycle of crime, poverty, and substance abuse.

Working together — it's how we're making our communities better places to live and work.

ATLANTA AUGUSTA CHARLOTTE DUBAI NEW YORK
RALEIGH STOCKHOLM WASHINGTON WINSTON-SALEM

www.KilpatrickStockton.com



Sarah Wilson
Fine Art Photography



Thank you to the many donors, volunteers and guests that made our first-annual CocoaVin an incredible success!

Meet the Board

Ginger Doherty Summit House Charlotte



New to the Summit House Charlotte board in December 2009, Ginger was introduced to Summit House by Paula Weller. Paula, a Summit House Piedmont board member for the past 12 years, is a long-time family friend and past employer of Ginger's. "Paula and

her family live around the corner from my parents. I watched their son three days a week while I was in college," she remembers.

"I wanted to give back to the community and Summit House seemed the perfect fit. This is my first board position and I'll never forget my first Summit House strategic planning meeting at Piedmont Natural Gas. Two of the mothers from the house stood up and spoke about their life experiences, their commitment to the program, and their incredible commitment to changing their lives. They were very inspiring.

I also like Summit House because it is a smaller organization. I can directly see and feel the impact that we have on the lives of the mothers and children in the program, as well as in the community. I feel part of the organization; it is a homey feeling."

Born and raised in Greensboro, North Carolina, Ginger currently lives with her three-year-old son Ian and their cat Critter. Her family hails from North Carolina: her parents still reside in Greensboro, her sister lives in Raleigh. A graduate of University of North Carolina at Greensboro with a bachelor of science in accounting, Ginger holds her CPA license in both New York and North Carolina. "I've lived in Charlotte for 12 years," said Ginger, "but I have also lived in Upstate New York and Boston." Ginger also loves yard work, gardening, flowers, and mowing the grass exclaiming, "That's my favorite smell in the world, freshly mown grass."

Ginger has been the Manager of Financial Planning and Analysis for SPX Corporation for the past five years. SPX, a Fortune 500 industrial manufacturer, is almost 100 years old, that auspicious date arriving in 2012. "SPX started out in the automotive industry in Muskegon, Michigan, in 1912," stated Ginger, "they were one of the first parts suppliers to Henry Ford!" With little link to the automotive industry since their diversification in 2005, SPX is now a major supplier of cooling towers, primarily used in power plants, large arenas and office buildings, and is a multi-industry company that supplies the components and technologies to build global infrastructure, optimize food processing technologies, make energy production more efficient and much more.

"I love working for SPX," said Ginger. "I couldn't work for a better company. There is no bureaucracy, what you see is what you get. It has a great work environment; once you prove yourself, SPX will give you the space you need to grow."

Ginger also recruits and mentors for the SPX Rotational Program, a management training and leadership track. She always has one person that rotates through her group. "The whole point of the program is to elevate folks to another level in their professional career. Though very challenging, it is incredibly rewarding to help people and watch them grow through the program. It is a lot of fun to watch folks graduate and take on full-time, permanent positions. The parallel between the Rotational Program and Summit House is uncanny. I know that is a big reason I'm very drawn to and supportive of Summit House."

SPX has extended their reach of programs such as this by partnering with Summit House in its mission to change the lives of mothers and children through education, mentoring, parenting skills, and life and job skills training. The \$10,000 grant from SPX to Summit House will assist multiple mothers in making dramatic life changes to become productive, tax-paying members of our communities, with safe children who are ready to learn in school.

Welcome Ginger! Summit House is honored to have you on our board.



Summit House thanks SPX for their commitment to their community and for their \$10,000 grant to support the mothers and children that come to Summit House to change their lives!!



Nationwide Insurance Foundation Grant



In their continuing support of Summit House, the Nationwide Insurance Foundation granted \$10,000 in support of our residential program for women and children. Since 2007, Nationwide has been a staunch supporter of the Summit House families and we are proud to partner with this exceptional organization.

"The Nationwide Insurance Foundation is proud to support Summit House and the critical service it provides for the community," said Chad Jester, president of the Nationwide Insurance Foundation. "Summit House provides mothers and their children a chance to make lasting changes in their lives and build a foundation for becoming productive members of the community."

The Nationwide Insurance Foundation is an independent corporation funded by contributions from Nationwide companies including Nationwide Insurance and Nationwide Financial. Founded in 1959, the Nationwide Insurance Foundation has committed more than \$250 million since 2000 to help nonprofit organizations in communities where Nationwide associates and their families live and work. Just as Nationwide supports its customers in their moment of need, the company's involvement in its home communities is focused on supporting organizations that help people facing critical or immediate need.

Families of All Ages Celebrate Mother's Day



Each year on Mother's Day we honor the Summit House mothers for their determination and commitment to creating new lives for themselves and for their children. On May 8, 2010, the O.Henry Hotel in Greensboro graciously opened its ballroom to host the Summit House Piedmont's Second Annual Mother's Day Tea and Hat Soiree.

More than 80 people gathered at the O.Henry Hotel to enjoy its old-world charm and to celebrate with multi-generations of mothers and families from very young children to great grandparents. The Summit House staff and board members pampered the Summit House families and each of the guests with afternoon tea, finger sandwiches and chocolate-dipped strawberries; each mother was presented with a long-stemmed red rose generously donated by Clemmons Florist.

Local artist Mary Redmon spent the day painting happy young faces while Megan Sultan and the Children's Museum African American Atelier Group created works of art for the children to take home. VF Jeanswear, Jackie Nelson,

Macaroni Grill and Regal Grande Cinema donated door prizes, and photographer Larry Lackey shared his time and talents — more pictures can be viewed on our website at www.summithouse.org.

A warm thank you to everyone who made our Second Annual Mother's Day Tea such a wonderful success. We look forward to seeing you next year!

One Cause, Two Organizations

Summit House and Goodwill Industries, Inc. of Greensboro (serving five Triad counties) partnered to collect computers, electronic devices, clothing and household items over the course of four weekends. Raffles of \$25 gift certificates for local Panera Bread, Chic-fil-A, Earth Fare, and Walmart were held each weekend.

Summit House will receive vouchers for our mothers to use to purchase items for themselves and their children in the Goodwill Industries retail stores. Our most recent graduate received one of these vouchers and was able to furnish most of her apartment!

Our thanks to Goodwill Industries, local businesses and communities for your support!



CocoaVin

Wines by:



Chocolates by:



Thank you to our CocoaVin silent auction sponsors:

518 West

Annetta Johnson

ArtSource (North Hills)

B&B Jewelers

Bev Dwane Image Consultant

Canvas on Demand



Carolina Ballet

Carolina Club

Carolina Hurricanes

Diamonds Direct Crabtree

Diane McKinney

Douglas Carroll Salon

Floral Dimensions

Gabrielle Collection Vineyards

Gold's Gym

Homewood Nursery and Garden Center

Lowes Foods

Linda Craft Real Estate Team

Lush

Magnolia Grill

Mutual Distributing Company

Natural Body Spa

Overman Pottery

Pampered Chef

Prestonwood
Country Club

Salon Blu

Salutations

Skin Sense

Speak America

The Fresh Market -
Falls of Neuse Road

Umstead Hotel and Spa

Wine & Things



Mothers serving time where they're needed most...with their children.



A whole-way house.

Summit House Piedmont
PO Box 13568

Greensboro, NC 27405

Phone 336.375.9344 Fax: 336.375.9384
oshelia@summithouse.org

Summit House Charlotte
PO Box 620670

Charlotte, NC 28262

Phone 704.717.2522 Fax 704.717.2669
donna.price@summithousecharlotte.org

Summit House Triangle
PO Box 27284

Raleigh, NC 27611

Phone 919.329.9214 Fax 919.329.9216
denna@summithouseenc.org

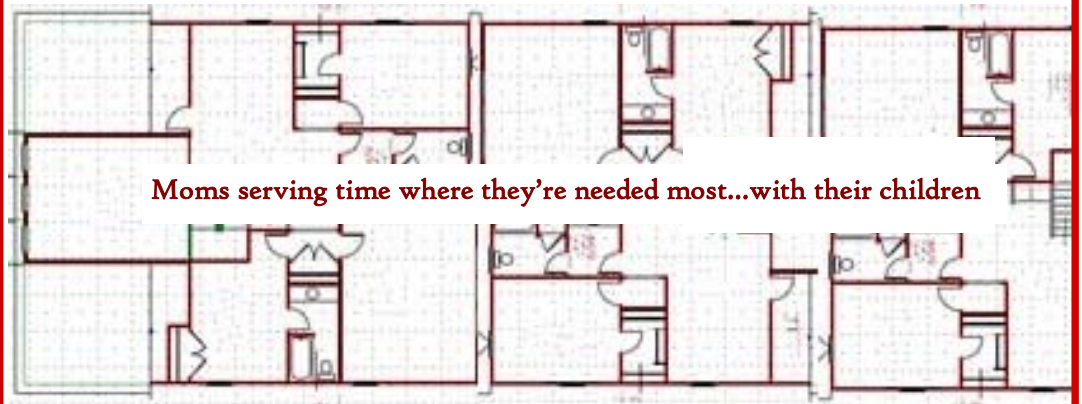

Moms serving time where they're needed most...with their children

About Summit House

Summit House, a residential alternative-to-prison program for mothers convicted of a non-violent crime and their minor children, is a non-profit that serves all 100 North Carolina counties and saves state tax payers over \$million net annually. With locations in the Triangle*, Piedmont and Charlotte, Summit House empowers convicted mothers to break the multigenerational cycle of poverty, violence, and substance abuse that is their history, and to create a new life for themselves and their children. Summit House strives to keep families together by maximizing healthy bonding between mothers and children. The organization is committed to working with women who have the desire and dedication to change their lives through counseling, life and job skills training, and substance-abuse counseling, rather than sit out a prison sentence

More information about Summit House can be accessed through www.summithouse.org.

** The Triangle home is in transition to a new location*

Summit House is a White House Presidential Award Winner



A whole-way house.

1st Annual **Summit House** *Statewide Golf Tournament*

Monday, June 21st, 2010

Quarry Hills Country Club in The Village of Swepsonville

Space is Limited! Sign up early!

Summit House is a residential alternative-to-prison program for mothers convicted of a non-violent crime and their minor children. Instead of mom going to prison and her children going into foster care or being shuffled between family or friends (sometimes many different people), mom and her kids are able to remain together as a family at Summit House while mom works towards putting their lives back together.

Come join us for a fun day of golf and fellowship to celebrate Summit House.

Contact: Linda Higgins at (336) 263-2211 for reservations

Captain's Choice (Scramble) Format - If you can hold a club you are good enough!
Golf Registration 10:30 AM - Lunch 11:30 AM - Shotgun Start 12:15 PM

Sponsorship Opportunities

Senior Sponsorships \$2,500 (includes fee for 3 teams & Logo Recognition)
Junior Sponsorships \$1,000 (includes fee for 1 team & Logo Recognition)

Team Sponsorship \$300
Hole Sponsorship \$250

Sponsorship opportunities and tickets are available through ww.summithouse.org